

# 2600A-PLUS ESTATE BROADCAST SPREADER ASSEMBLY and OPERATING INSTRUCTIONS

**EarthWay®**  
EV-N-SPRED

IF YOU ARE MISSING ANY PARTS, HAVE ANY DIFFICULTY IN ASSEMBLY, OR HAVE ANY QUESTIONS REGARDING THE SAFE OPERATION OF THIS SPREADER, PLEASE CONTACT US. THIS MODEL INCLUDES **LIFETIME TECHNICAL SUPPORT** HOT LINE: 574-848-7491 or 800-294-0671, EMAIL: TECHSUPPORT@EARTHWAY.COM

## HELPFUL HINTS: REVIEW THE DIRECTIONS BEFORE ASSEMBLY

- ☑ Make sure the **ARROW** on the gear box points to the front of the spreader. The impeller must turn clockwise. Reversing the gearbox will cause the impeller to turn counter clockwise. Clean the impeller plate after each use. Fertilizer stuck on the impeller blades will cause uneven spreading.
- ☑ Your spreader is designed to be pushed at three miles per hour, which is a brisk walking speed. Slower or faster speeds will change the spread patterns. Wet fertilizer will also change the spread pattern and flow rate. Clean and dry your spreader thoroughly after each use. A coating of light spray oil on all metal parts will help prevent corrosion, pay special attention to coating *the inside* of the steel tubing.
- ☑ Gears are permanently lubricated at the factory. Do not open the gearbox or dirt may enter.

1. Remove and identify all loose parts from carton.

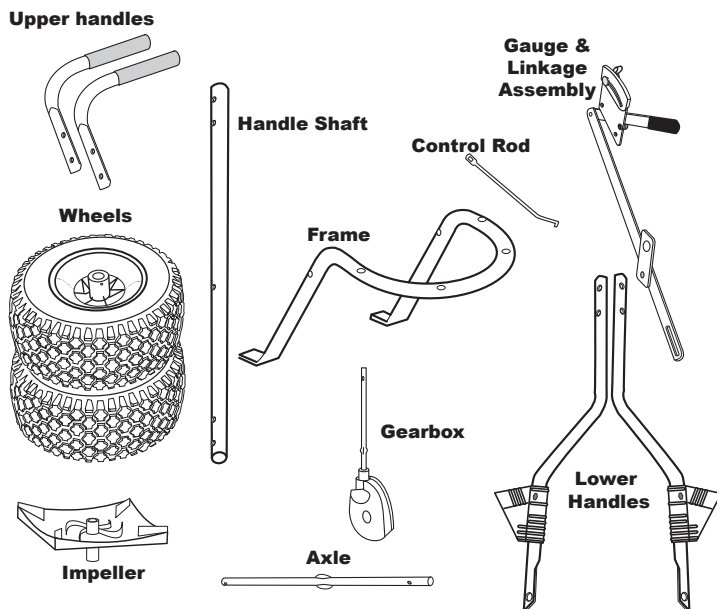

2. Position hopper as shown to the right. Install Frame using (4) #10 x 1/4" Flat Head Phillips screws. **TIGHTEN THESE NOW**

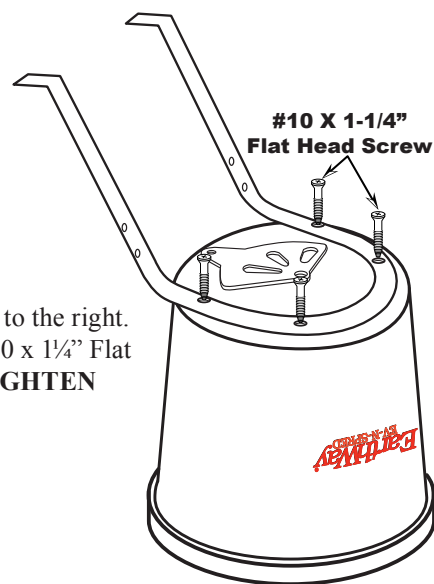

3. Install gear box by inserting the pinion shaft into hole in center of hoppers bottom. The **ARROW** on the gearbox must point to **FRONT** of the hopper. Follow label instructions on hopper.

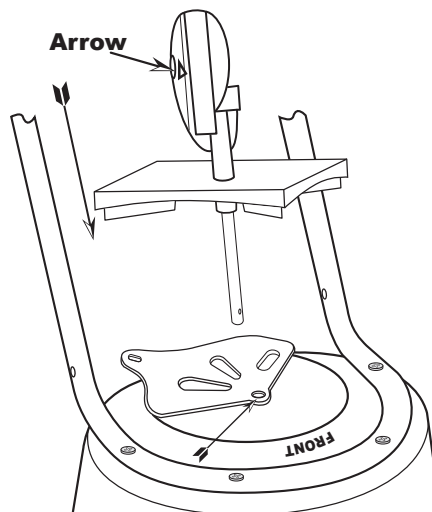

4. Install lower handles onto Frame and secure with 1/4-20 x 2 1/4" bolt through hole in Frame Braces and through the hole in frame install locknut.

NEXT, SLIDE THE AXLE (COAST WHEEL SIDE FIRST) through the right side lower handle and into the gearbox (with the arrow facing the FRONT), you will need to rotate the axle to engage with the gearbox, then through the left side lower handle.

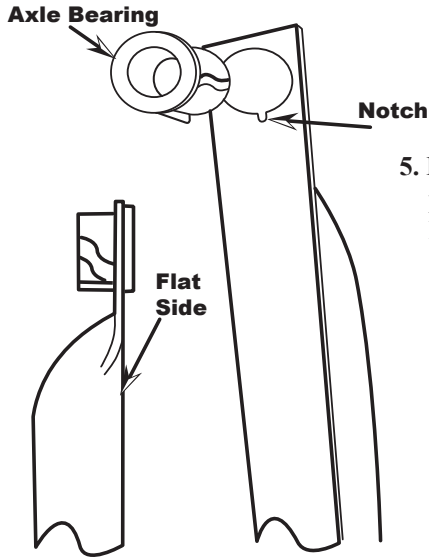

5. Install the bearings over the axle and press into the notches of the lower handle as shown above.

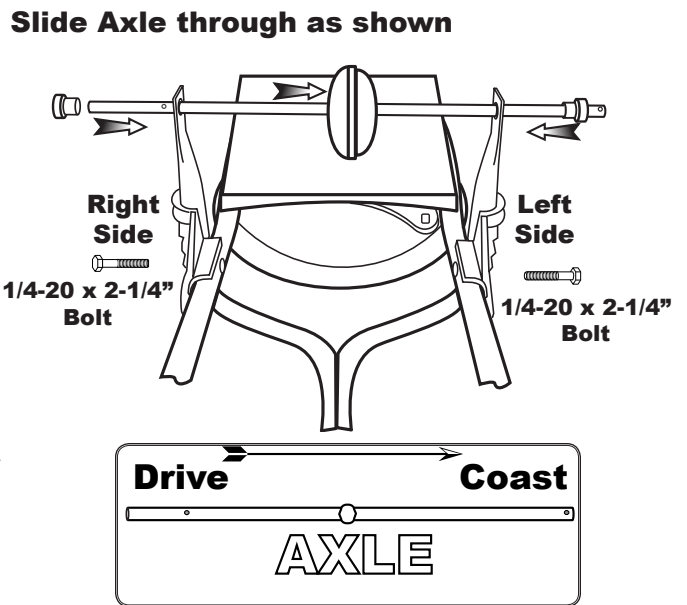

33107  
1/8" X 1-3/4" Cotter Pin



33106  
1/8" X 3/4" Cotter Pin

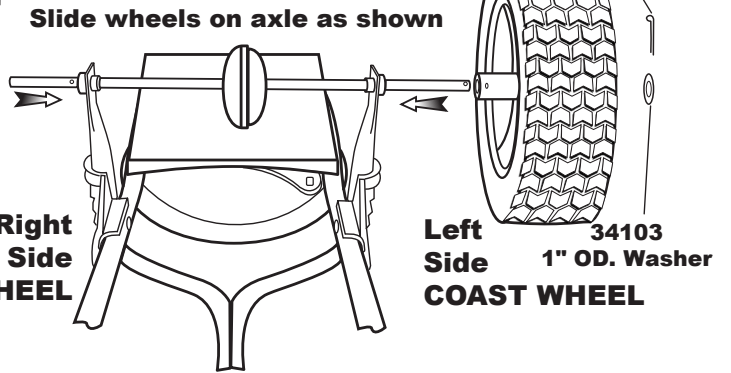

**NOW GO BACK AND TIGHTEN ALL NUTS AND BOLTS, DO NOT OVER TIGHTEN.**

6. Install drive wheel to axle using pin hole nearest to lower handles as shown. Insert 1 3/4" Cotter pin through wheel and through axle. Bend with pliers to prevent pin from falling out.

7. Install coast wheel to axle using outside pin hole. As shown, add the flat washer, and insert 3/4" Cotter pin through axle (not thru the wheel). Bend with pliers to prevent pin from falling out.

**IMPORTANT**

**TURN SPREADER UPRIGHT ON TO WHEELS.**

8. Install Handle Shaft as shown below using (2) 1/4-20 x 1 1/2" Hex Bolt and (2) 1/4-20 Locknuts

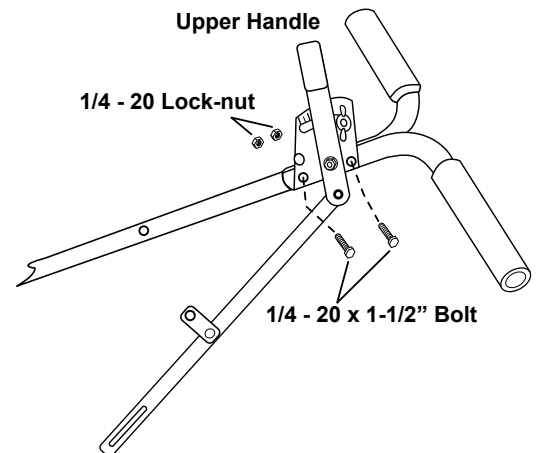
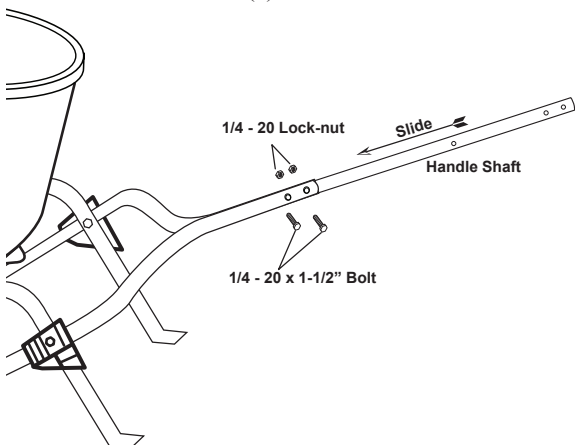

9. Insert (2) 1/4-20 x 1 1/2" Hex Bolt through Gauge and Linkage Assembly, then through the Upper Handle, Handle Shaft, Upper Handle and secure with (2) 1/4-20 Locknuts as shown at the right.

10. Attach Linkage Pivot with 1/4-20 x 1 1/2" Hex Bolt, Flat Washer, Spacer and Locknut as shown below. Next, install Control Rod into the Shut-Off Plate as shown at the right. **TIP:** Make sure that the Control Rod is above the Lower Handles.

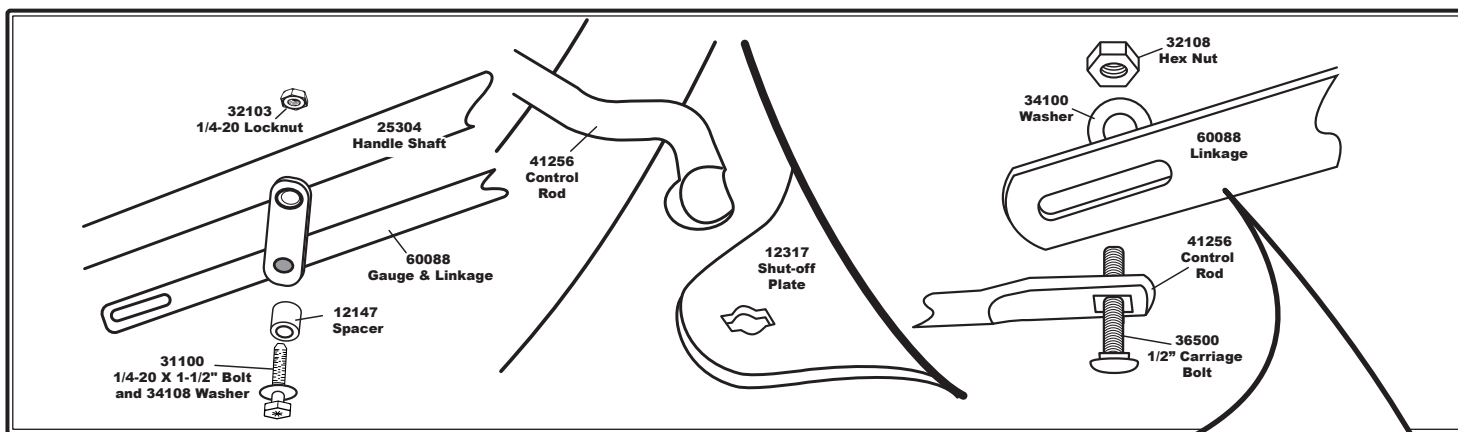
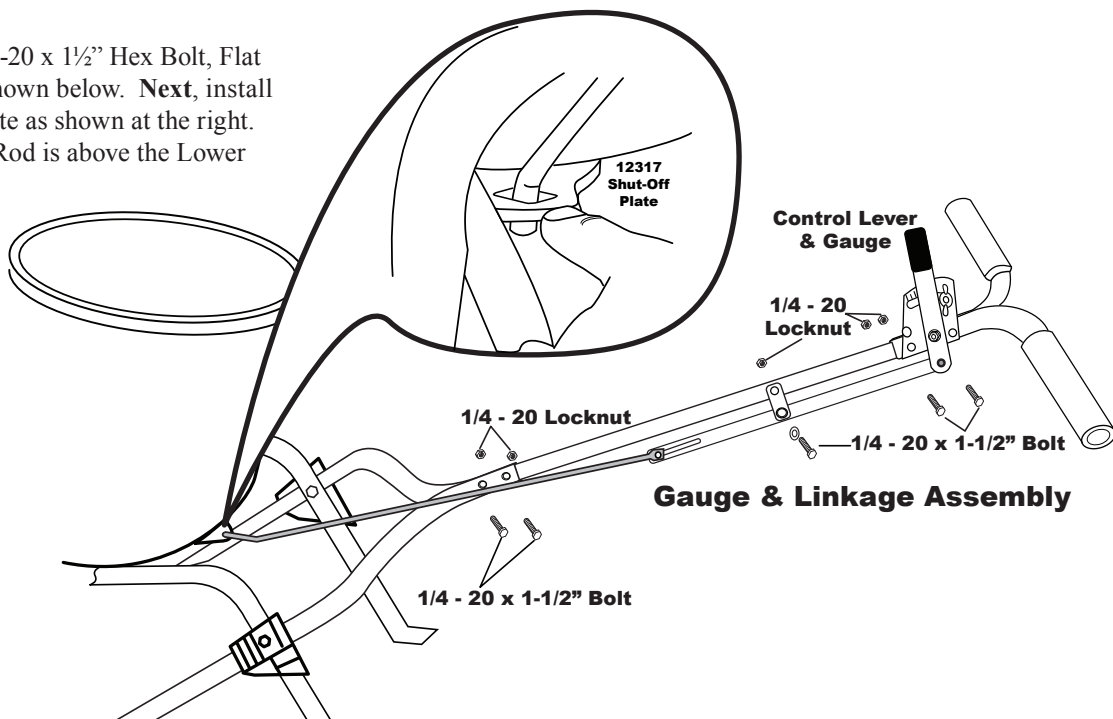

11. Using 1/2" Carriage Bolt, install through the Control Rod, Linkage and install the Flat Washer and secure with Hex Nut to a loose fit to allow for CALIBRATION below. See above right and below for details.

12. **CALIBRATION:** THIS STEP ENSURES THAT YOUR SPREADER IS PROPERLY ADJUSTED TO GIVE YOU A CORRECT STARTING POINT TO APPLY MATERIALS AT THE CORRECT SETTING. Pull the Control Lever back to #30 on the Gauge, then push the shut-off plate forward until the shut-off and the drop holes are fully open. Now tighten the Hex Nut on the 1/2" Carriage Bolt on the Linkage Assembly. Check to confirm calibration by closing the Control Lever, then reopening to #30 and confirm that the drop holes are fully open.

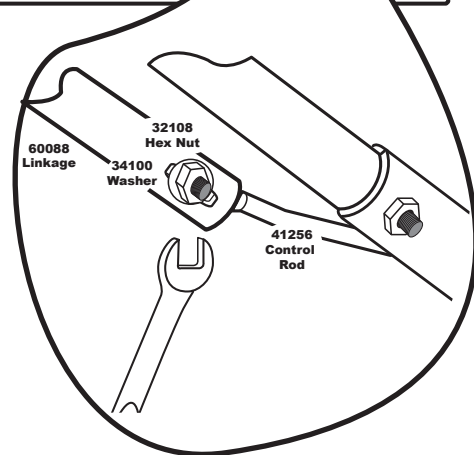

13. Insert agitator to pinion shaft on inside of hopper. **NOTE:** Position of flat side of the agitator as shown at the right.

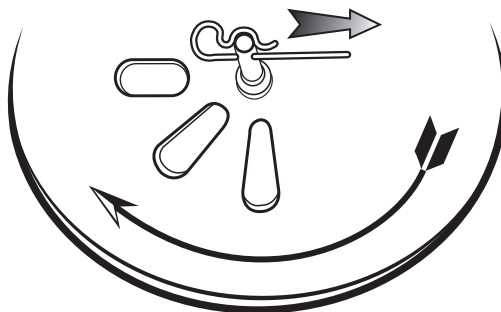

## 5-YEAR LIMITED WARRANTY

Earthway Products, Inc. warrants this product to be free of defects in original workmanship and materials for a period of 5-Years to the end user with the original purchase receipt. If a manufacturing non-conformance is found, Earthway Products, Inc. at its discretion will repair or replace the part(s) or product at no charge provided the failure is not the result of incorrect installation, mishandling, misuse, tampering, or normal wear and tear as determined by Earthway. Earthway at its discretion may require that the part(s) or product be returned along with the original purchase receipt at owners' expense for examination and compliance with the terms of this warranty. Do not return any product without first receiving authorization from Earthway Products, Inc. To seek remedy under this warranty, contact Earthway Products, Inc. at 574-848-7491, techsupport@earthway.com or write to Earthway Products, Inc. P.O. Box 547 Bristol, Indiana 46507 and describe the nature of the manufacturing defect. **SPECIFIC LIMITATIONS:** This warranty covers only the part(s) or product; any labor charges associated with repair or replacement of non-conformances are specifically excluded. Due to the corrosive nature of most fertilizers and ice melt products, Earthway Products, Inc. makes no warranty against and specifically excludes part(s) or product degradation or failure due to corrosion or its effects. Clean and dry your spreader thoroughly after each use, as a preventative measure, coat all metal parts (inside of tubing) with a light oil or silicon spray.

## OPERATING INSTRUCTIONS

### **Before filling hopper, become familiar with the operation of this spreader.**

1. Obtain proper setting for material to be used from the RATE SETTING MATRIX included with this spreader.
2. Move stop bolt on rate gauge assembly to the proper setting for the material that you are spreading.
3. While pushing spreader forward, pull the Control Lever back to stop bolt.
4. To stop, push lever forward to close flow holes before you stop moving.
5. When finished, empty any remaining material from hopper.
6. Thoroughly wash spreader and allow to dry before storing. Spray all metal surfaces (inside & outside) with WD-40 or other light oil to help prevent corrosion.

The settings furnished on the **Rate Setting Matrix** are intended as a guide only. Variations in physical characteristics of material applied, walking speed, and roughness of ground surface may require slightly different spreader settings. Due to the above conditions, the manufacturer makes no warranty as to the uniformity of coverage actually obtained from the settings listed.

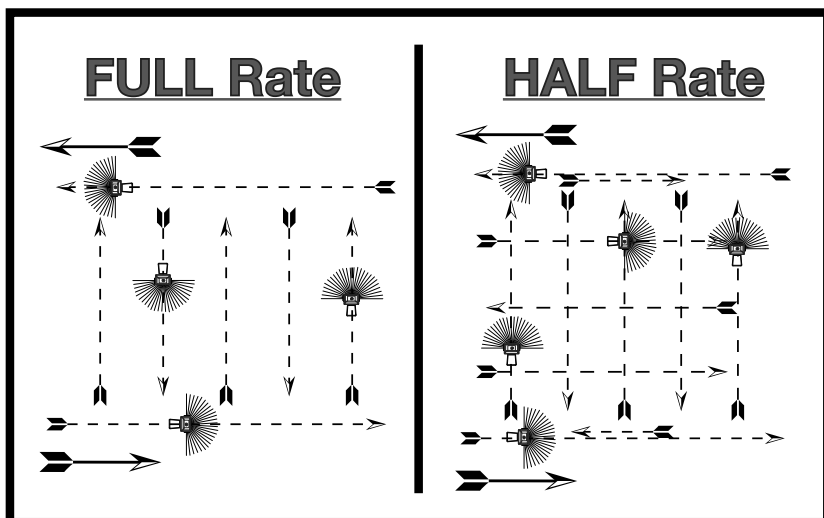

### **HOW TO ORDER SPARE PARTS**

All spare parts listed herein may be ordered direct from the manufacturer. Be sure to give the following information when ordering.

- Model Number
- Part Number
- Part Description

You can contact us by calling (574) 848-7491 or 800-294-0671 to place an order using a credit card.

Or online at [www.earthway.com/parts](http://www.earthway.com/parts)  
Questions? [parts@earthway.com](mailto:parts@earthway.com)

Earthway Products, Inc.  
P.O. Box 547  
Bristol, IN 46507  
Phone: 574-848-7491  
or 800-294-0671  
www.earthway.com

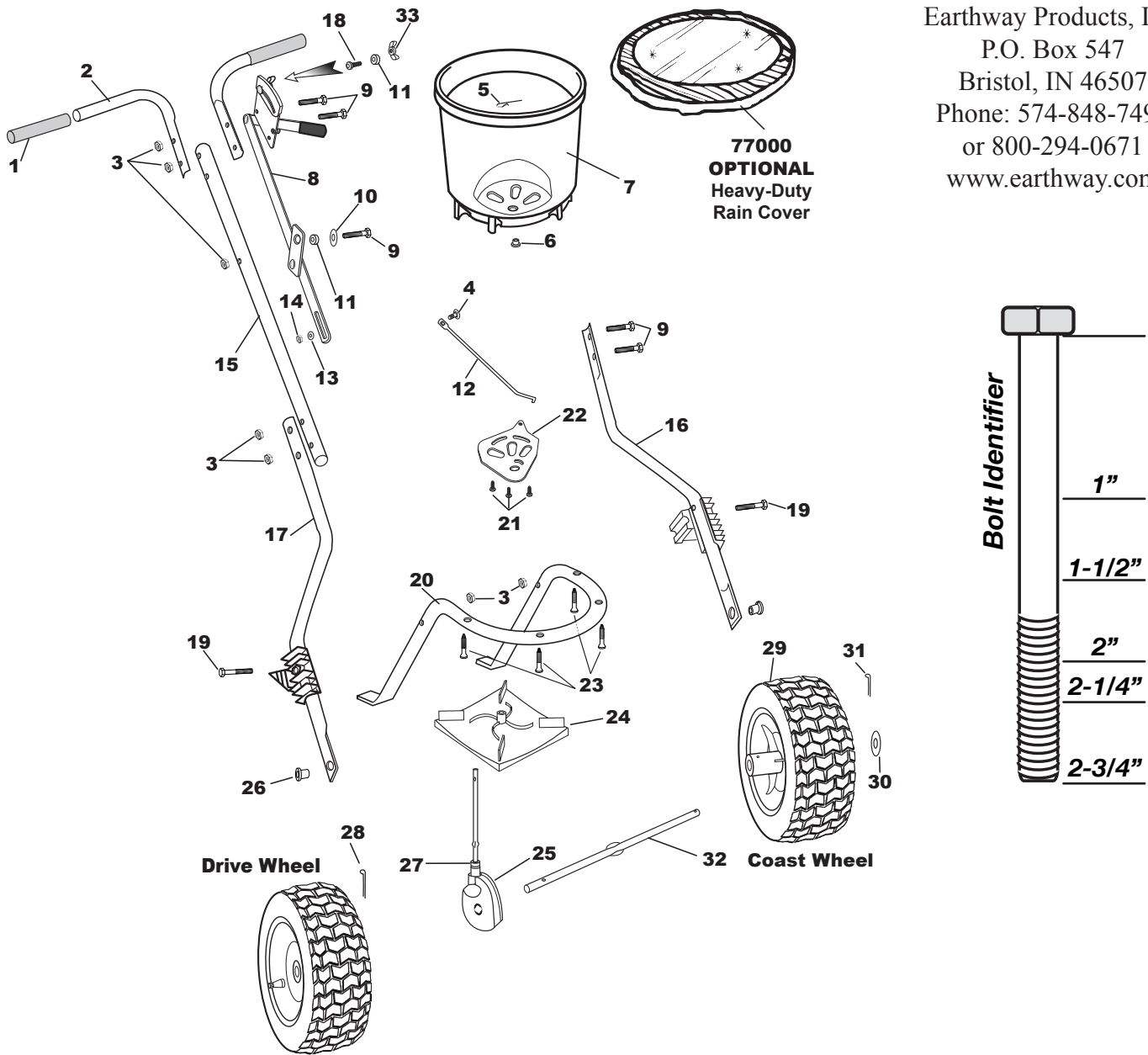

## 2600A Plus Broadcast Spreader ~ Parts List

Key #	Part #	Description	Key #	Part #	Description
1	19115	.875" ID. X 4" IL. BLACK GRIP (2600A)	18	37100	1/4-20 X 1" CARRIAGE BOLT ZINC
2	25403	UPPER HANDLE (2600A)	19	31106	1/4-20 X 2 1/4" HHCS ZINC
3	32103	1/4-20 NYLON INS LOCKNUT ZINC	20	25107	FRAME (2000A/2950B/2600A/2600APlus)
4	36500	#10-24 X 1/2" CARRIAGE BOLT SS	21	31138	#8 X 3/8" PMT #8 HD COARSE BLACK
5	33117	AGITATOR	22	12317	SHUT OFF PLATE (2600B) BLACK
6	12220	GEAR BOX BUSHING (2050)	23	31108	#10 X 1 1/4" TYPE A FHPS ZINC
7	60089	HOPPER ASSEMBLY 2600A/2950B	24	12248	IMPELLER DISHED (PLUS UNITS 2030, 2600A)
8	60088	GAUGE & LINKAGE ASSEMBLY 2600A	25	60451	GEAR BOX ASSEMBLY 2030PI
9	31100	1/4-20 X 1 1/2 HHMS ZINC	26	12167	SPACER BEARING (2600A-PLUS)
10	34108	9/16" OD. X .257 ID. WASHER ZINC	27	12206	DUST COVER (GEAR BOX) RND
11	12147	SPACER (PIVOT LINK)	28	33107	1/8" X 1 3/4" COTTER PIN S.S.
12	41256	CONTROL ROD (2600A)	29	70149	9 IN PNEUMATIC WHEEL
13	34100	#10 FLAT WASHER S.S (L AN)	30	34103	1"OD X 17/32"ID X 1/32" WASHER ZINC
14	32108	10-24 HX. NUT ZINC PLATED	31	33106	1/8" X 3/4" COTTER PIN ZINC
15	25304	HANDLE SHAFT (2600A)	32	23519	AXLE (PLUS SERIES PNEUMATIC SPREADERS)
16	25210L	LOWER HANDLE (2950B/2600A)Assembly - Left	33	60027	WING NUT ASSEMBLY BLACK
17	25210R	LOWER HANDLE (2950B/2600A)Assembly - Right			

# Broadcast Setting Matrix

## Calibration Techniques

### How to ensure your spreader is properly calibrated

Make sure the drop holes in the bottom of the hopper are fully open when the Rate Control handle is on #30. If not, please adjust control cable or control rod to allow for a full open hopper position at #30.

### Rod Type Adjustment

1. Open the shut-off so that the drop holes are completely open as illustrated to the right.
2. Review the Control Lever position - if it is set so that the forward edge is at #30, you are calibrated. If not, you need to adjust the control rod at the pivot bracket shown in Fig 1.
  - A. If your shut-off is not able to open fully as in step #1. Loosen the top nut a few turns, then loosen the lower nut so that it allows you to push the shut-off open fully. Next tighten each nut so that they contact the pivot bracket without moving it, and then carefully tighten each nut fully so they do not loosen during use. Recheck adjustment as outlined in #1 above.
  - B. If your shut-off is able to open fully as in step #1, but the Control Lever is not at #30. Loosen the top nut a few turns, then loosen the lower nut so that it allows you to push the Control Lever to #30. Next tighten each nut so that they contact the pivot bracket without moving it. Carefully tighten each nut fully so they do not loosen during use. Recheck adjust as outlined in #1 above.

### Cable Type Adjustment

1. Open the Control Lever so that the shut-off and drop holes are completely open as illustrated above right.
2. Review the Control Lever position so that the indicator is pointed to #30, if it is your calibration is correct. If not you need to adjust the control cable at the cable clamp on the underside of the hopper as shown in Fig 2.
  - A. If your shut-off is not able to open fully as in step #1. Loosen the cable clamp screw slightly so that you can slide the outer cable out so that the shut-off is fully open. Next tighten the cable clamp screw securely. Recheck adjustment as outlined in #1 above.
  - B. If your shut-off is able to open fully as in step #1, but the Control Lever is not at #30. Loosen the cable clamp screw slightly so that you can slide the outer cable in so that the Control Lever opens to #30. Next tighten the cable clamp screw securely. Recheck adjustment as outlined in #1 above.

If you have any questions regarding the operation or assembly of your spreader please call us at 800-294-0671 or 574-848-7491 Monday - Friday 9:00am - 4:00pm Eastern. Accessories and Repair Parts are also available at these numbers.

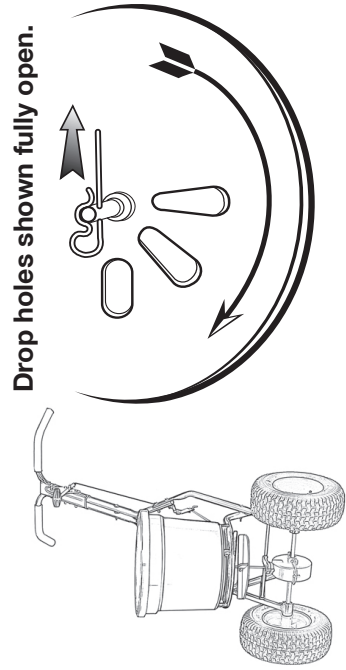
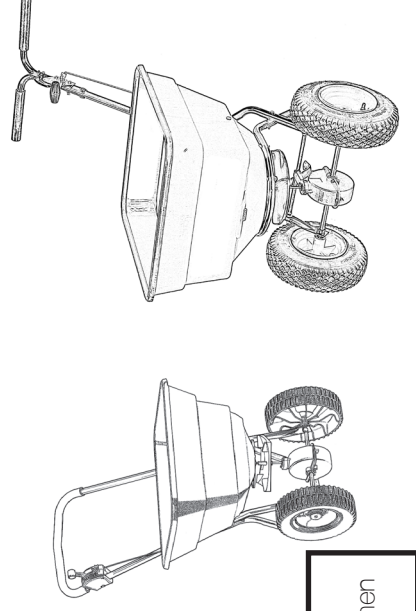
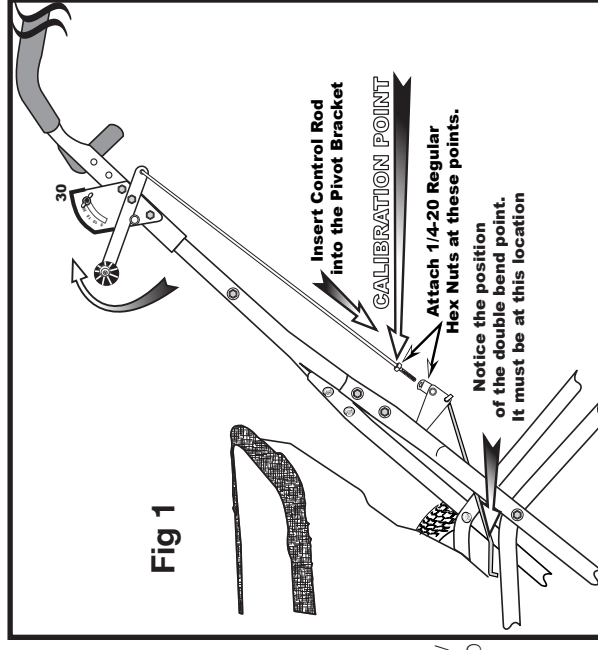

## ESTABLISHING A SETTING RATE

**Step 1:** Use **Chart 1** to estimate the number of LBS/1,000 square feet of coverage (Example: 20 LB. bag with 10,000 square foot coverage = 2.0 LBS/1,000 square feet)



**Step 2:** Find the closest LBS/1,000 square feet in **Chart 2** that you estimated using **Chart 1** (Example: 2.0 LBS/1,000 square feet = Spreader Setting of 13)

**Step 3:** Determine the Spread Width by evaluating the particle or seed size in



**Chart 3** to determine the Spread Width between Spread Paths

CHART 1	BAG COVERAGE IN SQUARE FEET		
	5,000	10,000	15,000
	LBS/1,000 SQ FT		
5 LBS.	1.0	0.5	0.3
10 LBS.	2.0	1.0	0.7
15 LBS.	3.0	1.5	1.0
18 LBS.	3.6	1.8	1.2
20 LBS.	4.0	2.0	1.3
25 LBS.	5.0	2.5	1.7
30 LBS.	6.0	3.0	2.0
35 LBS.	7.0	3.5	2.3
40 LBS.	8.0	4.0	2.7
45 LBS.	9.0	4.5	3.0
50 LBS.	10.0	5.0	3.3

CHART 2		
GRAMS/SQ METER	LBS./1,000 SQ FT	SPREADER SETTING
5 Grams	1.0 LBS.	11
10 Grams	2.0 LBS.	13
15 Grams	3.0 LBS.	14
20 Grams	4.0 LBS.	16
25 Grams	5.0 LBS.	17
30 Grams	6.0 LBS.	18
35 Grams	7.0 LBS.	19
40 Grams	8.0 LBS.	20
45 Grams	9.0 LBS.	22
50 Grams	10.0 LBS.	23

CHART 3		
SPREAD WIDTHS FOR DIFFERENT PARTICLE SIZES		
Particle Size	English	Metric
	5-7ft.	1.5-2.1m
	7-9ft.	2.1-2.7m
	9-12ft.	2.7-3.7m

SPREAD WIDTH FOR DIFFERENT SIZE GRASS SEED		
Seed Size	English	Metric
	5-7ft.	1.5-2.1m
	7-10ft.	2.1-3.1m

## METRIC RATE SETTING

### Determining a Setting Rate

Use chart below to determine the **Setting Rate** based on **Grams/Square Meter** of coverage as directed on the bag.

**All spread widths are determined by particle size and weight.**

## SPREAD PATHS

### FULL Rate (one pass)

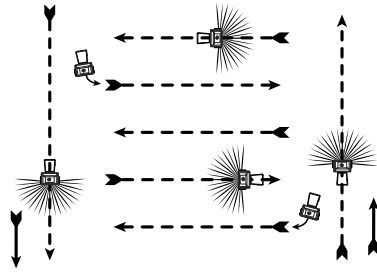

### HALF Rate (two passes)

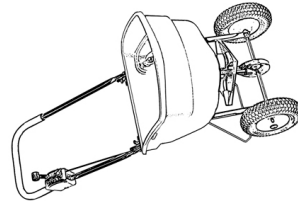
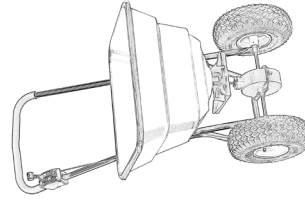
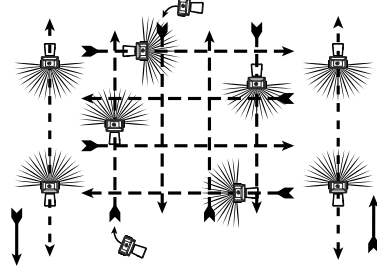

**Maintain a consistent walking speed of 2-3mph or the application rate will change.**

© 2014 Earthway Products, Inc. All rights reserved

The settings furnished on the Rate Setting Matrix are intended as a guide only. Variations in physical characteristics of material applied, walking speed, and roughness of ground surface may require slightly different spreader settings. Due to the above conditions, EPI makes no warranty as to the uniformity of coverage actually obtained from the settings listed.